

# Die Zauberflöte

A Singspiel in two acts by Wolfgang Amadeus Mozart

Libretto by Emanuel Schikander

First performed: Festival 2019



Bill Cooper

## CREATIVE TEAM

Direction and Design ..... Barbe & Doucet  
Puppet Designer and  
Puppet Coach ..... Patrick Martel  
Lighting Designer ..... Guy Simard

## CHORUS BREAKDOWN

11 Tenors  
10 Basses  
9 Sopranos  
9 Mezzos  
3 Singing boys  
6 Puppeteers (2 female, 4 male)

## TECHNICAL PERSONNEL

16 Stage Crew  
3 Flymen  
6 Stage Managers  
7 Lighting Crew  
2 Follow Spots  
1 AV Operator  
9 Running Wigs  
7 Make-Up  
4 Running Wardrobe  
11 Dressers

## SPECIAL EFFECTS

Puppets  
Low smoke  
2 Strobes  
Magic lantern (wireless DMX)  
Exploding bottles (compressed air)  
3 Pyros  
3 Miniature smoke machines  
21 LED illuminated hats and books (wireless DMX)  
Wax crockery

## TRANSPORT

8 High Cube Containers or  
8 Megacube Trailers (approximately)







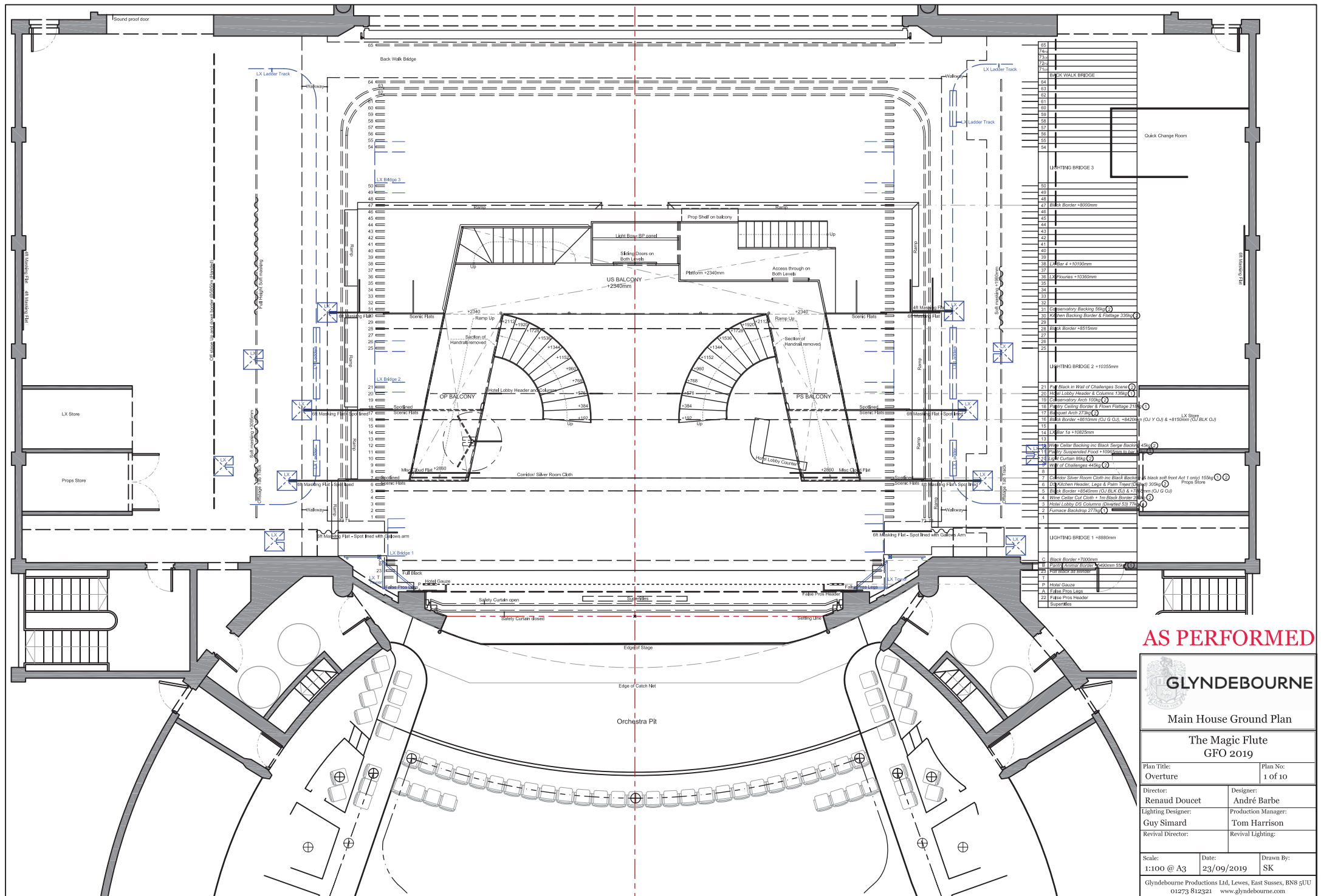

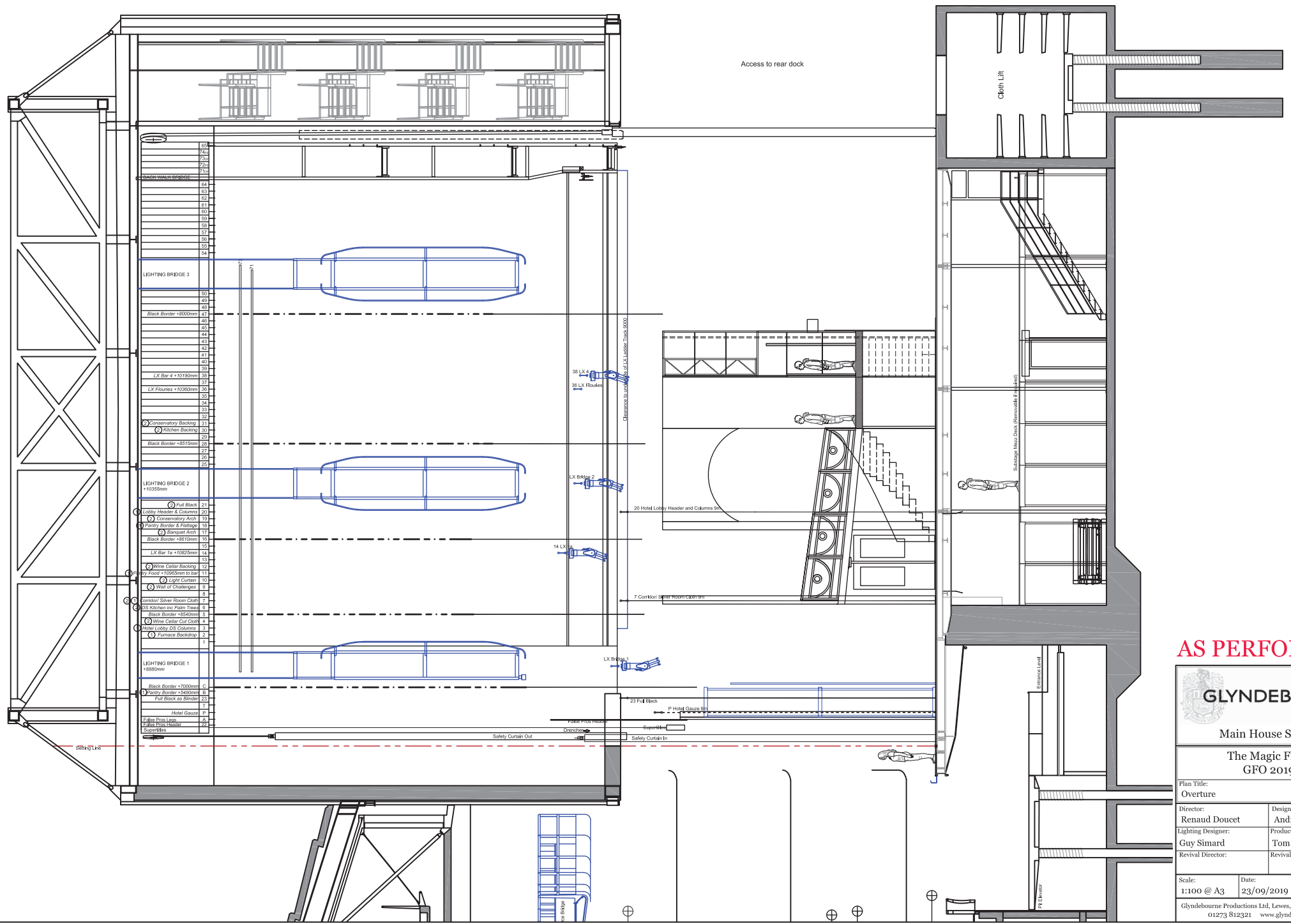

AS PERFORMED

**GLYNDEBOURNE**

**Main House Section**

**The Magic Flute**  
**GFO 2019**

Plan Title: <b>Overture</b>	Plan No: <b>1 of 10</b>
Director: <b>Renaud Doucet</b>	Designer: <b>André Barbe</b>
Lighting Designer: <b>Guy Simard</b>	Production Manager: <b>Tom Harrison</b>
Revival Director:	Revival Lighting:

Scale: <b>1:100 @ A3</b>	Date: <b>23/09/2019</b>	Drawn By: <b>SK</b>
-----------------------------	----------------------------	------------------------

Glyndebourne Productions Ltd, Lewes, East Sussex, BN8 5UU  
01273 812321 www.glyndebourne.com



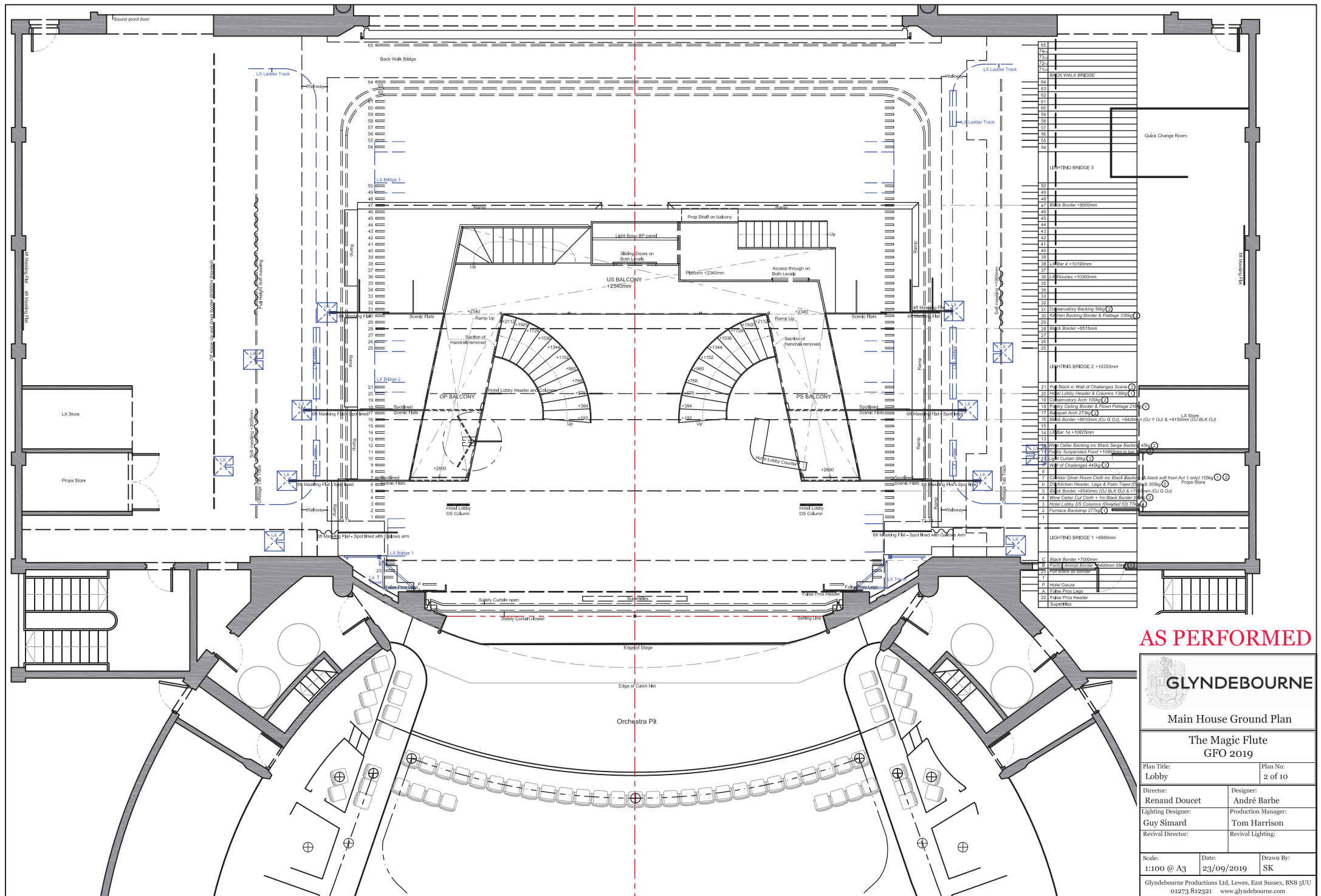

AS PERFORMED



**GLYNDEBOURNE**

Main House Ground Plan

The Magic Flute

GFO 2019

Plan Title: Lobby	Plan No: 2 of 10
Director: Renaud Doucet	Designer: André Barbe
Lighting Designer: Guy Simard	Production Manager: Tom Harrison
Revival Director:	Revival Lighting:

Scale:  
1:100 @ A3

Date:  
23/09/2019

Drawn By:  
SK

Glyndebourne Productions Ltd, Lewes, East Sussex, BN8 5UU

01273 812321 www.glyndebourne.com



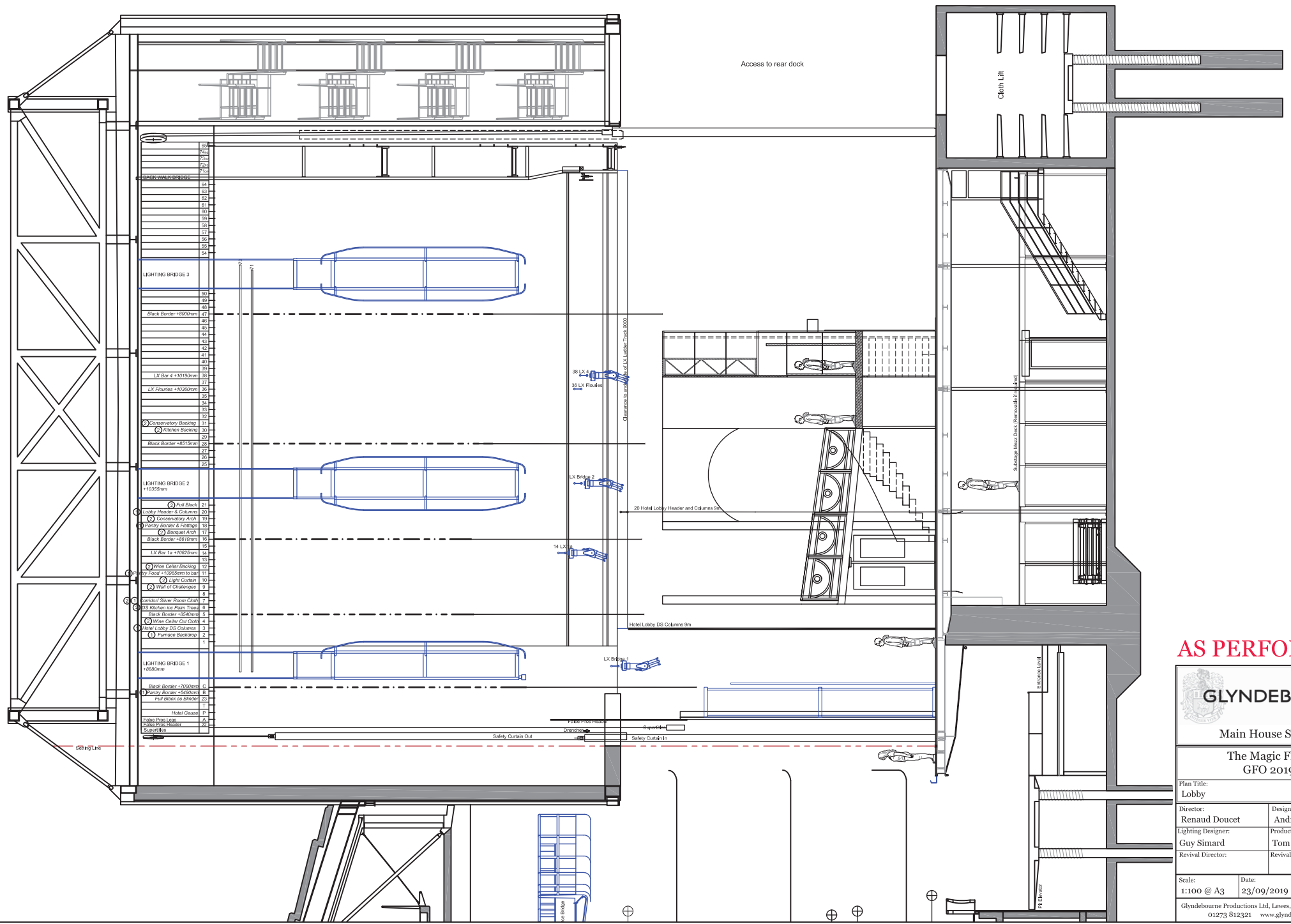

AS PERFORMED

 <b>GLYNDEBOURNE</b>		
Main House Section		
The Magic Flute GFO 2019		
Plan Title: Lobby	Plan No: 2 of 10	
Director: Renaud Doucet	Designer: André Barbe	
Lighting Designer: Guy Simard	Production Manager: Tom Harrison	
Revival Director:	Revival Lighting:	
Scale: 1:100 @ A3	Date: 23/09/2019	Drawn By: SK
Glyndebourne Productions Ltd, Lewes, East Sussex, BN8 5UU 01273 812321 www.glyndebourne.com		







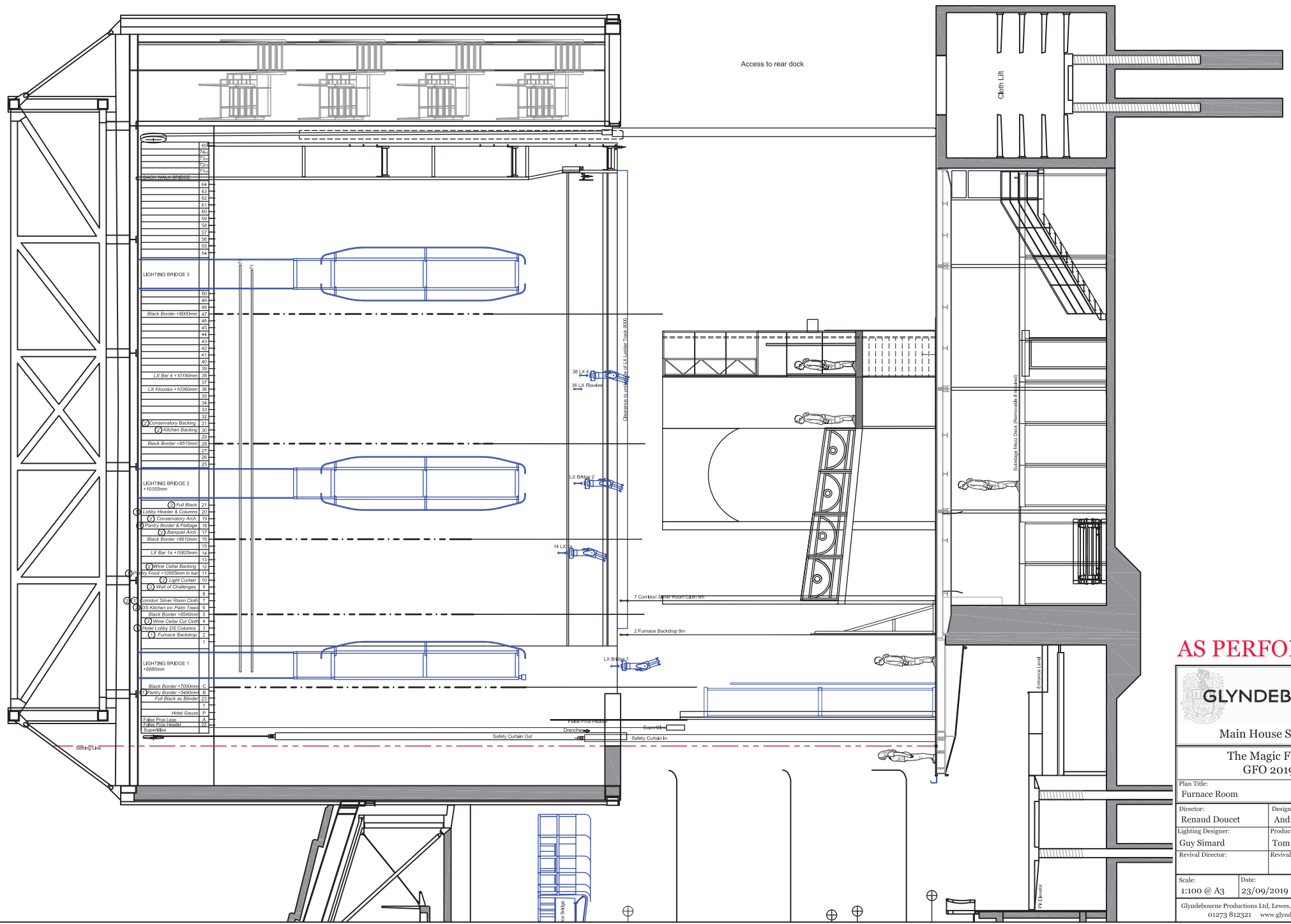

AS PERFORMED

 <b>GLYNDEBOURNE</b>		
Main House Section		
The Magic Flute GFO 2019		
Plan Title: Furnace Room	Plan No: 3 of 10	
Director: Renaud Doucet	Designer: André Barbe	
Lighting Designer: Guy Simard	Production Manager: Tom Harrison	
Revival Director:	Revival Lighting:	
Scale: 1:100 @ A3	Date: 23/09/2019	Drawn By: SK
Glynedebourne Productions Ltd, Lewes, East Sussex, BN8 5LU 01273 812321 www.glynedebourne.com		





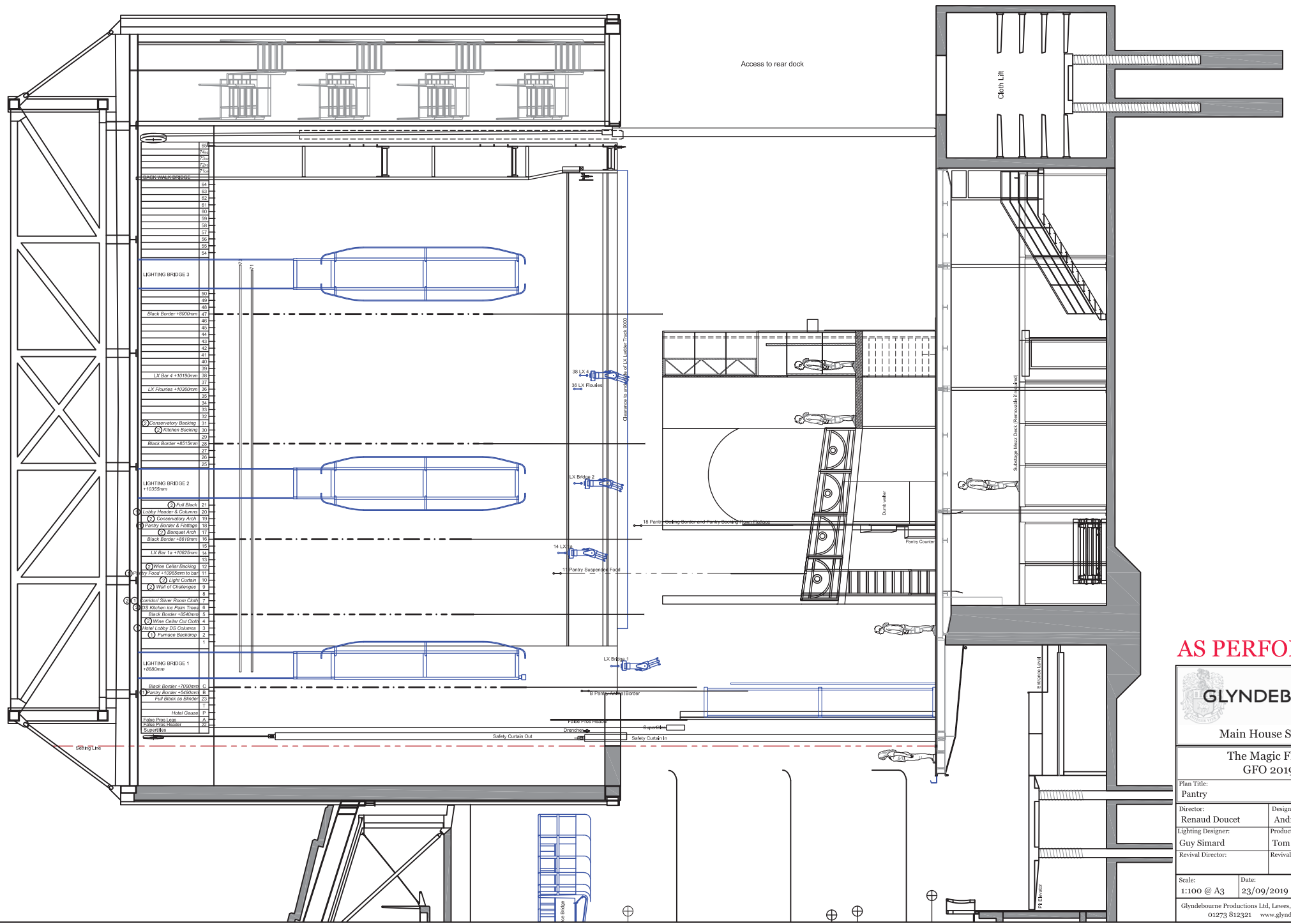

AS PERFORMED

 <b>GLYNDEBOURNE</b>		
Main House Section		
The Magic Flute GFO 2019		
Plan Title: Pantry	Plan No: 4 of 10	
Director: Renaud Doucet	Designer: André Barbe	
Lighting Designer: Guy Simard	Production Manager: Tom Harrison	
Revival Director:	Revival Lighting:	
Scale: 1:100 @ A3	Date: 23/09/2019	Drawn By: SK
Glyndebourne Productions Ltd, Lewes, East Sussex, BN8 5UU 01273 812321 www.glyndebourne.com		



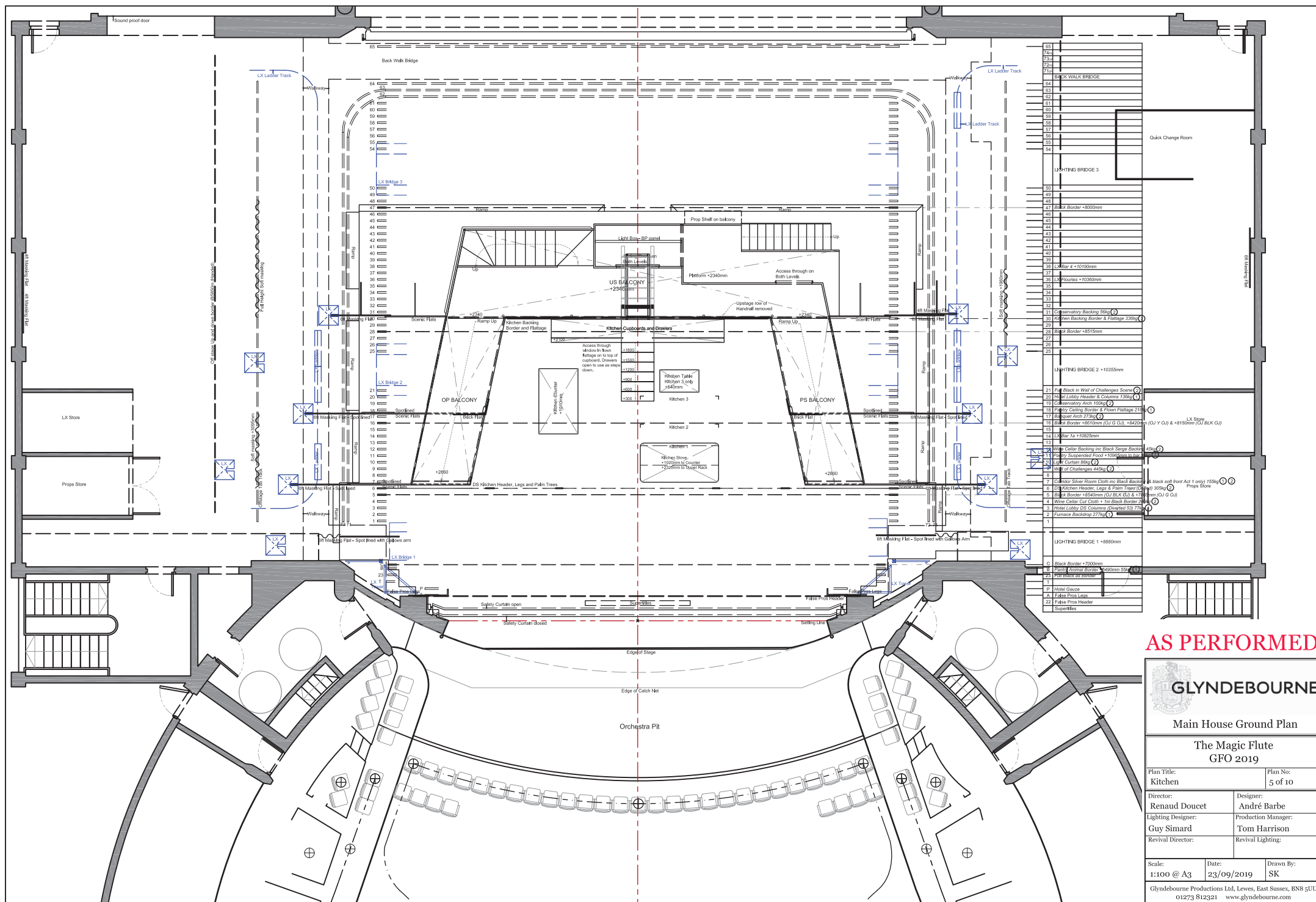

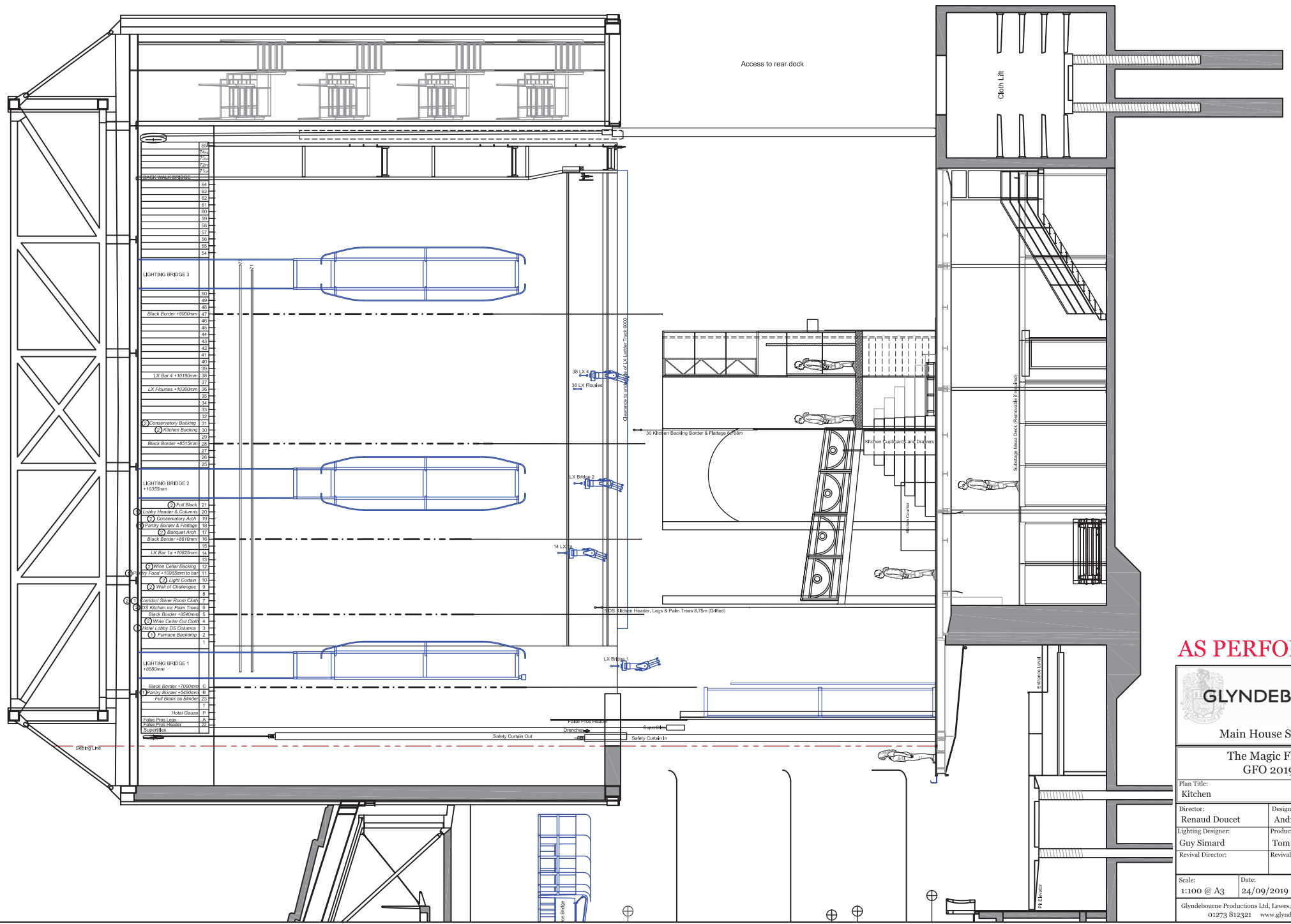

AS PERFORMED

 <b>GLYNDEBOURNE</b>		
Main House Section		
The Magic Flute GFO 2019		
Plan Title: Kitchen		Plan No: 5 of 10
Director: Renaud Doucet		Designer: André Barbe
Lighting Designer: Guy Simard		Production Manager: Tom Harrison
Revival Director:		Revival Lighting:
Scale: 1:100 @ A3	Date: 24/09/2019	Drawn By: SK
Glyndebourne Productions Ltd, Lewes, East Sussex, BN8 5UU 01273 812321 <a href="http://www.glyndebourne.com">www.glyndebourne.com</a>		





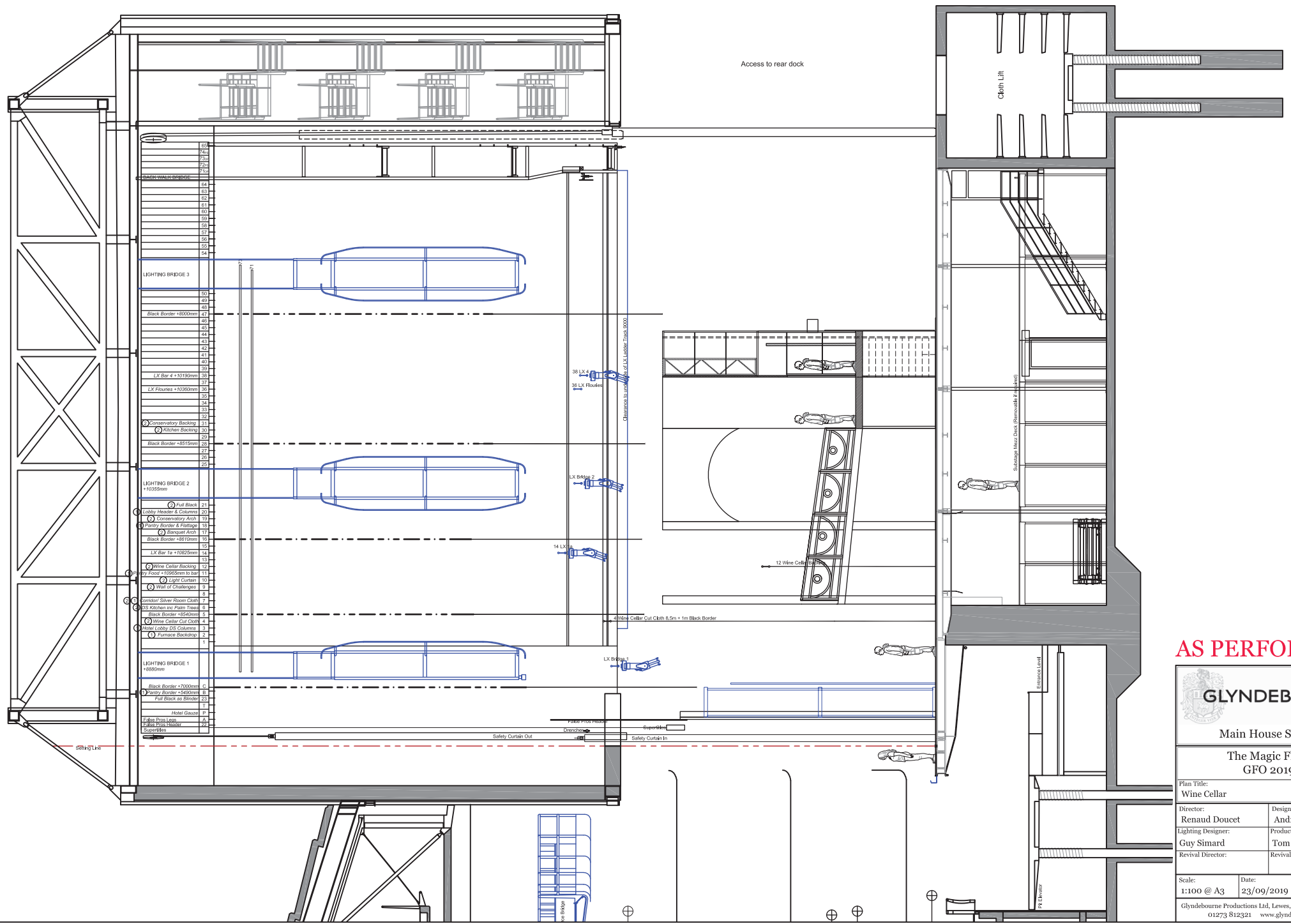

AS PERFORMED

 <b>GLYNDEBOURNE</b>		
Main House Section		
The Magic Flute GFO 2019		
Plan Title: Wine Cellar		Plan No: 6 of 10
Director: Renaud Doucet		Designer: André Barbe
Lighting Designer: Guy Simard		Production Manager: Tom Harrison
Revival Director:		Revival Lighting:
Scale: 1:100 @ A3	Date: 23/09/2019	Drawn By: SK
Glynede Bourne Productions Ltd, Lewes, East Sussex, BN8 5UU 01273 812321      www.glynedebourne.com		





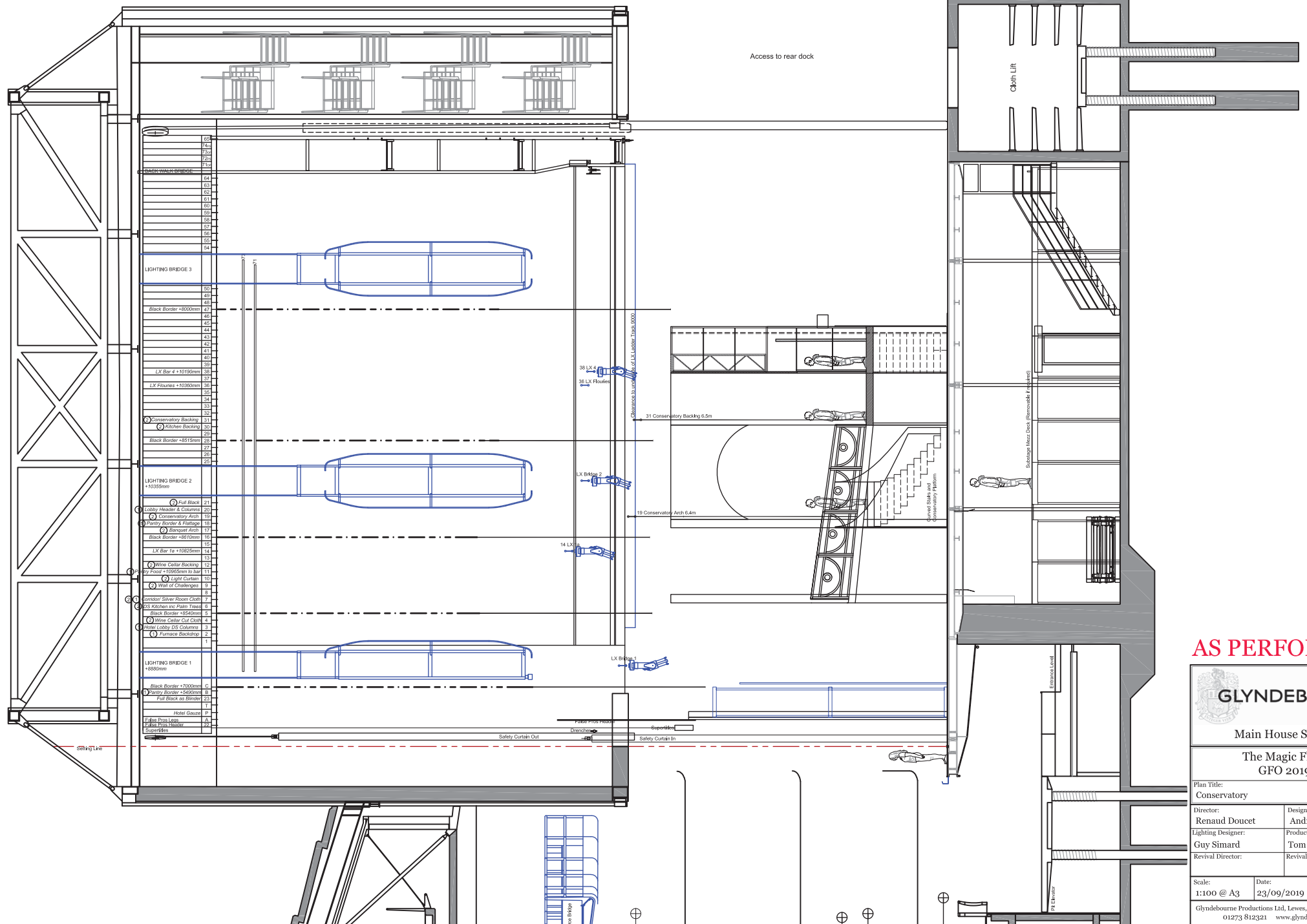

AS PERFORMED

 <b>GLYNDEBOURNE</b>		
Main House Section		
The Magic Flute GFO 2019		
Plan Title: Conservatory		Plan No: 7 of 10
Director: Renaud Doucet	Designer: André Barbe	
Lighting Designer: Guy Simard	Production Manager: Tom Harrison	
Revival Director:	Revival Lighting:	
Scale: 1:100 @ A3	Date: 23/09/2019	Drawn By: SK
Glynedebourne Productions Ltd, Lewes, East Sussex, BN8 5UJ 01273 812321 <a href="http://www.glynedebourne.com">www.glynedebourne.com</a>		





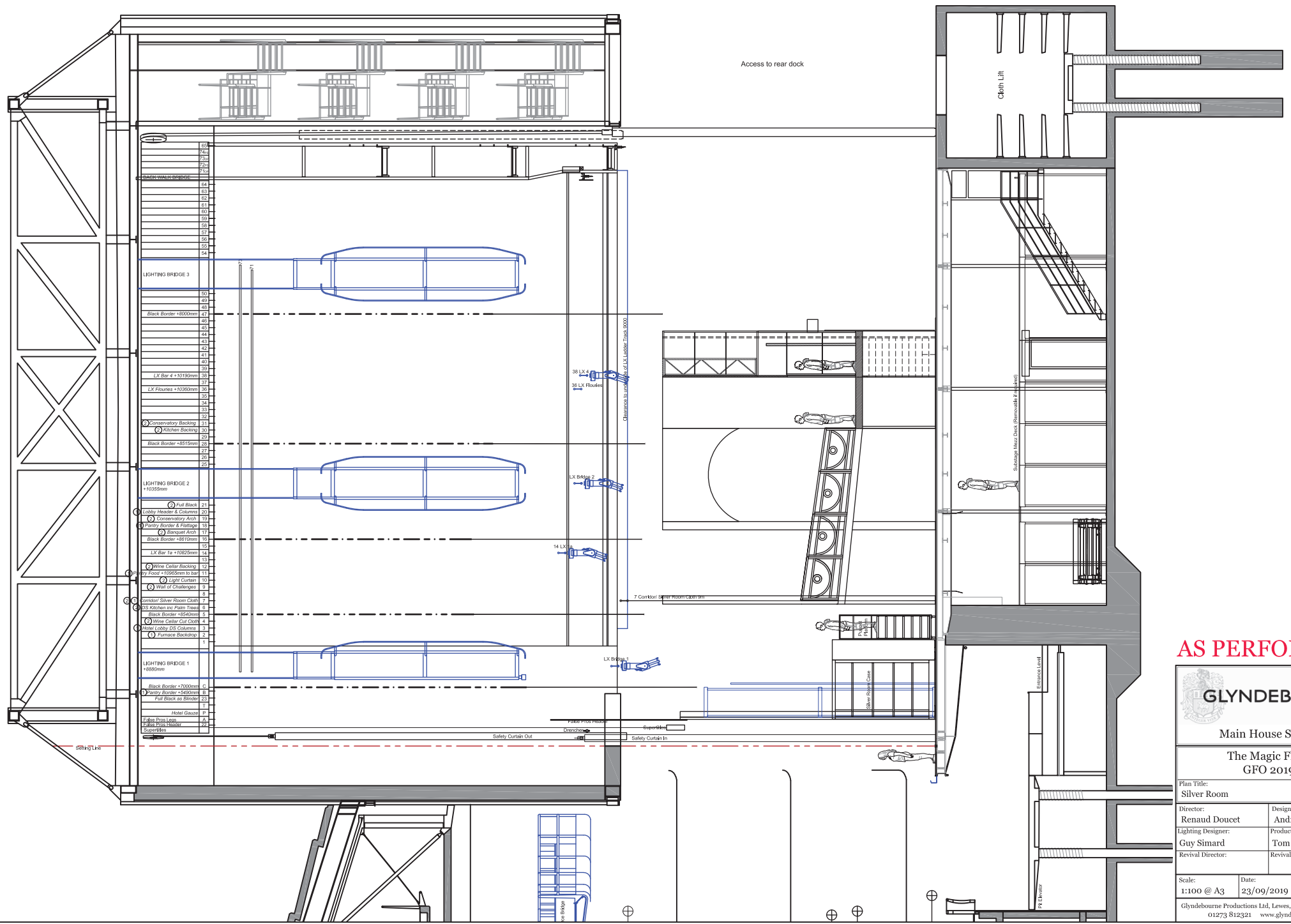

AS PERFORMED

 <b>GLYNDEBOURNE</b>		
Main House Section		
The Magic Flute GFO 2019		
Plan Title: Silver Room	Plan No: 8 of 10	
Director: Renaud Doucet	Designer: André Barbe	
Lighting Designer: Guy Simard	Production Manager: Tom Harrison	
Revival Director:	Revival Lighting:	
Scale: 1:100 @ A3	Date: 23/09/2019	Drawn By: SK
Glynedebourne Productions Ltd, Lewes, East Sussex, BN8 5UU 01273 812321 www.glynedebourne.com		









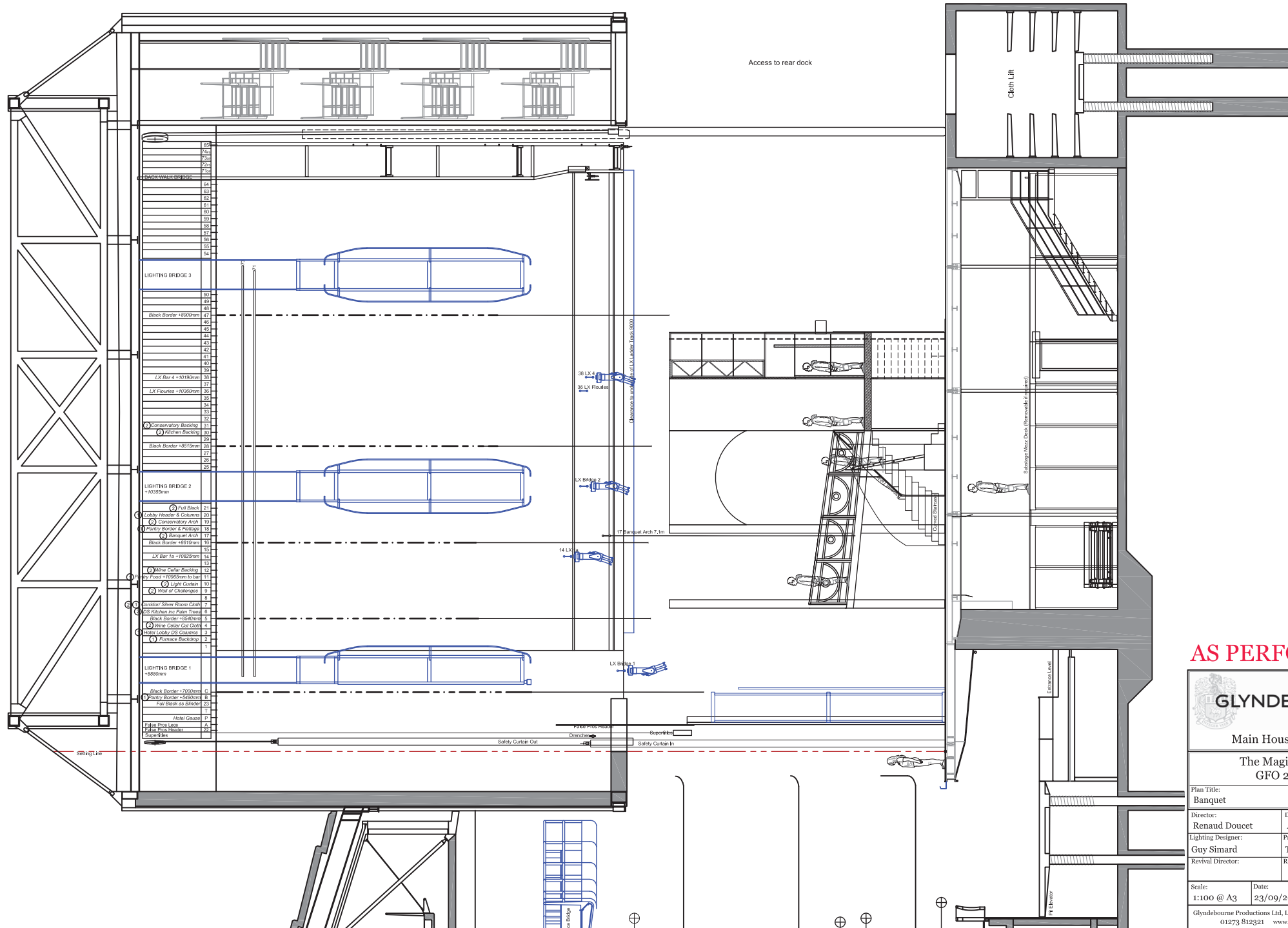

AS PERFORMED

 <b>GLYNDEBOURNE</b>		
Main House Section		
The Magic Flute GFO 2019		
Plan Title: Banquet		Plan No: 10 of 10
Director: Renaud Doucet		Designer: André Barbe
Lighting Designer: Guy Simard		Production Manager: Tom Harrison
Revival Director:		Revival Lighting:
Scale: 1:100 @ A3	Date: 23/09/2019	Drawn By: SK
Glyndebourne Productions Ltd, Lewes, East Sussex, BN8 5UU 01273 812321 <a href="http://www.glyndebourne.com">www.glyndebourne.com</a>		